

City of Laingsburg Development Department  
114 N Woodhull P.O. Box 178  
Laingsburg, MI 48848  
Ph: (517) 651-5374 Email: [clerk@laingsburg.us](mailto:clerk@laingsburg.us)  
<https://www.laingsburg.us/building-zoning/building-zoning-forms/>

## POLE BUILDING PERMIT CHECKLIST

### ZONING PERMIT

- \_\_\_\_\_ 1. Completed **Zoning Permit Application\***.
- \_\_\_\_\_ 2. **Proof of Ownership** if purchased within the last year.
- \_\_\_\_\_ 3. **Completed Site Plan Grid**
  - a. Minimum site plan requirements are listed on Page 4 of this packet.
  - b. A sample site plan grid is listed on Page 5 of this packet.
- \_\_\_\_\_ 4. **Soil Erosion and Sedimentation Review:** A soil erosion review is required by the State of Michigan through Shiawassee County Environmental Health. Additional information can be found [here](#).

### BUILDING PERMIT

(Contractors must be registered with the Building Department)

- \_\_\_\_\_ 1. Completed **Building Permit Application** form.
- \_\_\_\_\_ 2. **Blueprints and/or Plans:** A **complete** set of building and foundation plans and specifications, including a cross-section of the proposed project.
- \_\_\_\_\_ 3. Completed **Truss Drawings** submitted with this application packet.

APPLICATIONS WILL NOT BE PROCESSED UNTIL ALL DOCUMENTATION HAS BEEN RECEIVED

\*Commercial and Industrial construction requires Site Plan Review Approval

# APPLICATION for a ZONING PERMIT

City of Laingsburg

114 N Woodhull

P.O. Box 178

Laingsburg, Mi 48848

Phone: (517) 651-5374 • Fax: (517) 651-5512

Email: clerk@laingsburg.us

App. Date: \_\_\_\_\_ Receipt # \_\_\_\_\_ Fee: \$ \_\_\_\_\_ Permit # \_\_\_\_\_

Review Date: \_\_\_\_\_  Approved  Denied By: \_\_\_\_\_

Property Address/Location		Applicant (if not Owner)	
Address/Street: _____		Name: _____	
Nearest Cross Rd.: _____		Address: _____	
Township: _____		City/State/Zip: _____	
Parcel Number: _____		Phone: _____	
Zoning District: _____		Fax/Email: _____	
Owner Information		If New Construction or Addition	
Name: _____		<b>Please Attach All That Apply:</b> <input type="checkbox"/> Land Division Certificate <input type="checkbox"/> Survey <input type="checkbox"/> Proof of Ownership <input type="checkbox"/> Septic Permit # _____ Well Permit # _____ <input type="checkbox"/> Driveway Permit <input type="checkbox"/> Soil Erosion Permit <input type="checkbox"/> New Address <input type="checkbox"/> New Sewer Connection	
Address: _____			
City/State/Zip: _____			
Phone: _____			
Fax/Email: _____			
Type of Request		Yes	No
<input type="checkbox"/> Principal Structure			
<input type="checkbox"/> Accessory Structure			Did you attach a "Site Plan Drawing"?
<input type="checkbox"/> Agricultural Structure			Are you making grade (earth) changes?
<input type="checkbox"/> Temporary Structure/Use			Is your project within 500 ft. of surface water?
<input type="checkbox"/> Demolition Permit			Is this site currently violating the Ordinance?
<input type="checkbox"/> Sign			
<input type="checkbox"/> Home Occupation			
<input type="checkbox"/> Fence			
<input type="checkbox"/> Deck or Porch			
<input type="checkbox"/> Pool			
<input type="checkbox"/> Solar			
<input type="checkbox"/> Outdoor Solid Fuel Furnace			
<input type="checkbox"/> Shared Driveway			
<input type="checkbox"/> Buildable Lot Study			
<input type="checkbox"/> Hazardous Material Storage			
<input type="checkbox"/> Other:			
<b>For All Applications</b>			
<b>For Sign Permits Only</b>			
		Type of Business: _____	
		Total display area in square feet: _____	
		Proposed setback from Right-of-Way: _____	
		Sign height: _____ Sign purpose: _____	
		Type: <input type="checkbox"/> Pole <input type="checkbox"/> Ground <input type="checkbox"/> Wall <input type="checkbox"/> Other	
		Height and width of wall: _____	
		Attach Sign drawing showing copy <input type="checkbox"/>	
<b>Describe Proposed Building or Land Use:</b>			
_____			
_____			

**AFFIDAVIT OF COMPLIANCE**

I am the owner of, or the authorized agent of the owner, of the lot (parcel of land) described and shown on the attached site plan. I am familiar with the Shiawassee County Zoning Ordinance, including the related laws listed in Section 16.5.3. I hereby attest based upon my knowledge and belief that this request is complete, in compliance with, and warrants approval under the Shiawassee County Zoning Ordinance of 1999, as amended.

\_\_\_\_\_  
Signature of Applicant

\_\_\_\_\_  
Date



**City of Laingsburg**  
**114 N Woodhull Rd**  
**Laingsburg, MI 48848**

**Building Official: Rob Kehoe**  
 Phone: (810) 516-1191  
 Email: bldoff3889@aol.com

**120**  
**B 2024 B**

Authority: 1972 PA 230 Penalty: Failure to provide the information may result in denial of your request.	LAINGSBURG is an equal opportunity employer/program. Auxiliary aids, services and other reasonable accommodations are available upon request to individuals with disabilities.
---	--

Project or Facility Information			
PROJECT NAME		ADDRESS	
NAME OF CITY, VILLAGE OR TOWNSHIP IN WHICH JOB IS LOCATED			CITY
<input type="checkbox"/> City <input type="checkbox"/> Village <input type="checkbox"/> Township   OF:			ZIP CODE
COUNTY	BETWEEN	AND	

Applicant				
NAME			E-MAIL	
ADDRESS	CITY	STATE	ZIP CODE	TELEPHONE NUMBER (Include Area Code)

Owner of the land in fee on which the building or structure will be constructed				
NAME			ADDRESS	
CITY	STATE	ZIP CODE	TELEPHONE NUMBER (Include Area Code)	

Cost and Fees				
ESTIMATED PROJECT COST				
\$ _____				
Re-Open Expired Permit	\$40.00			
CERTIFICATE OF OCCUPANCY (\$50.00 FEE) <input type="checkbox"/> YES <input type="checkbox"/> NO	BUILDING PERMIT FEE ENCLOSED (The first \$100.00 of an application is non-refundable)   \$ _____		OR STATE ACCOUNT NUMBER _____	

Validation – For Department Use Only	Validation Area
USE GROUP _____ TYPE OF CONSTRUCTION _____ SQUARE FEET _____ APPLICATION FEE (non-refundable) \$ _____ CERTIFICATE OF OCCUPANCY <input type="checkbox"/> YES <input type="checkbox"/> NO \$ _____ NUMBER OF INSPECTIONS _____ \$ _____ TOTAL PERMIT FEE \$ _____ APPROVAL SIGNATURE _____	

Residential builder or Residential maintenance and alteration contractor			
NAME	COMPANY NAME	ADDRESS	
CITY	STATE	ZIP CODE	TELEPHONE NUMBER (Include Area Code)
STATE OF MICHIGAN LICENSE NUMBER			EXPIRATION DATE
FEDERAL EMPLOYER ID NUMBER (or reason for exemption)		WORKERS COMP INSURANCE CARRIER (or reason for exemption)	
UNEMPLOYMENT INSURANCE AGENCY EMPLOYER ACCOUNT NUMBER (or reason for exemption)			

Purpose of Project				
<input type="checkbox"/> NEW BUILDING	<input type="checkbox"/> ALTERATION	<input type="checkbox"/> DEMOLITION	<input type="checkbox"/> FOUNDATION ONLY	<input checked="" type="checkbox"/> RELOCATION
<input type="checkbox"/> ADDITION	<input type="checkbox"/> REPAIR	<input type="checkbox"/> MOBILE HOME SET-UP	<input type="checkbox"/> PREMANUFACTURE	<input type="checkbox"/> OTHER _____

Plan Review Required
<p>2 sets of construction documents are required with each application for a permit. Construction documents must be sealed and signed by an architect or professional engineer in accordance with 1980, PA 299 as amended. The seal and signature is not required for one- and two-family dwellings less than 3,500 square feet of calculated floor area and public works less than \$15,000 in total construction cost. Applicant must submit a detailed statement in writing, verified by affidavit of the individual making it, of the specifications for the building or structure, and full and complete copies of the plans drawn to scale of the proposed work. Applicant must also submit a site plan showing the dimensions, and the location of the proposed building or structure and the other buildings or structures on the same premises.</p>

Residential - Buildings Regulated by the Michigan Residential Code		
<input type="checkbox"/> ONE FAMILY	<input type="checkbox"/> TOWNHOUSE NO. OF UNITS _____	<input type="checkbox"/> DETACHED GARAGE
<input type="checkbox"/> TWO OR MORE FAMILY NO. OF UNITS _____	<input type="checkbox"/> ATTACHED GARAGE	<input type="checkbox"/> OTHER _____

Buildings Regulated by the Michigan Building Code		
<input type="checkbox"/> (A-1) ASSEMBLY (THEATRES, ETC.)	<input type="checkbox"/> (H-1) HIGH HAZARD (DETONATION)	<input type="checkbox"/> (M) MERCANTILE
<input type="checkbox"/> (A-2) ASSEMBLY (RESTAURANTS, BARS, ETC.)	<input type="checkbox"/> (H-2) HIGH HAZARD (DEFLAGRATION)	<input type="checkbox"/> (R-1) RESIDENTIAL 1 (HOTELS, MOTELS)
<input type="checkbox"/> (A-3) ASSEMBLY (CHURCHES, LIBRARIES, ETC.)	<input type="checkbox"/> (H-3) HIGH HAZARD (COMBUSTION)	<input type="checkbox"/> (R-2) RESIDENTIAL 2 (MULTIPLE FAMILY)
<input type="checkbox"/> (A-4) ASSEMBLY (INDOOR SPORTS, ETC.)	<input type="checkbox"/> (H-4) HIGH HAZARD (HEALTH HAZARD)	<input type="checkbox"/> (R-3) RESIDENTIAL 3 (1 & 2 FAMILY)
<input type="checkbox"/> (A-5) ASSEMBLY (OUTDOOR SPORTS, ETC.)	<input type="checkbox"/> (H-5) HIGH HAZARD (HPM)	<input type="checkbox"/> (R-4) RESIDENTIAL 4 (ASSISTED LIVING)
<input type="checkbox"/> (B) BUSINESS	<input type="checkbox"/> (I-1) INSTITUTIONAL 1 (SUPERVISED)	<input type="checkbox"/> (S-1) STORAGE 1 (MODERATE HAZARD)
<input type="checkbox"/> (E) EDUCATION	<input type="checkbox"/> (I-2) INSTITUTIONAL 2 (HOSPITALS ETC.)	<input type="checkbox"/> (S-2) STORAGE 2 (LOW HAZARD)
<input type="checkbox"/> (F-1) FACTORY (MODERATE HAZARD)	<input type="checkbox"/> (I-3) INSTITUTIONAL 3 (PRISONS ETC.)	<input type="checkbox"/> (U) UTILITY (MISCELLANEOUS)
<input type="checkbox"/> (F-2) FACTORY (LOW HAZARD)	<input type="checkbox"/> (I-4) INSTITUTIONAL 4 (DAY CARE ETC.)	

WILL THERE BE FIRE SUPPRESSION? <input type="checkbox"/> YES <input type="checkbox"/> NO	SCOPE OF WORK?
--	----------------

Type of Construction		
<input type="checkbox"/> 1A - Non-Combustible (Protected Structural Elements) 3HR	<input type="checkbox"/> 1B - Non-Combustible (Rated Structural Elements) 2HR	<input type="checkbox"/> 2A - Non-Combustible (Rated Structural Elements) 1HR
<input type="checkbox"/> 2B - Non-Combustible (Non-Rated Structural Elements)	<input type="checkbox"/> 3A - Non-Combustibles (Exterior Walls Only)	<input type="checkbox"/> 3B - Non-Combustible (Bearing Walls Rated)
<input type="checkbox"/> 4 - Heavy Timber	<input type="checkbox"/> 5A - Combustible (Structural Elements Rated) 1HR	<input type="checkbox"/> 5B - Combustible (All Elements Not Rated)

C. Dimensions / Data			
FLOOR AREA:	EXISTING	ALTERATIONS	NEW
BASEMENT	_____	_____	_____
1ST & 2ND FLOOR	_____	_____	_____
3RD FLOOR & ABOVE	_____	_____	_____
TOTAL AREA	_____	_____	_____



**Section 23a of the state construction code act of 1972, 1972 PA 230, MCL 125.1523a, prohibits a person from conspiring to circumvent the licensing requirements of this state relating to persons who are to perform work on a residential building or a residential structure. Violators of section 23a are subjected to civil fines.**

I, \_\_\_\_\_ (name), \_\_\_\_\_ (title), attest that the statements, specifications, and plans submitted with this application are true and complete and contain a correct description of the building or structure, lot or parcel, and proposed work. I further attest that this application complies with the requirements of MCL 125.1510 and that I am a person authorized under MCL 125.1510(2) to make the statements and attestations contained in this application under MCL 125.1510(2).

SIGNATURE

DATE

# City of Laingsburg INSPECTION INFORMATION

PART OF THE BUILDING PROCESS IS TO IDENTIFY THE JOB LOCATION AND HAVE INSPECTIONS DONE AT SPECIFIC STAGES DURING CONSTRUCTION. BEFORE AN INSPECTOR CAN PERFORM THEIR JOB THE PERMIT HOLDER SHALL OBSERVE THE FOLLOWING RULES.

- 1: THE BUILDING PERMIT OR COPY SHALL BE KEPT ON SITE UNTIL THE COMPLETION OF THE PROJECT.
- 2: THE SITE ADDRESS SHALL BE PROVIDED IN SUCH A POSITION TO BE PLAINLY VISABLE AND LEGIBLE FROM THE STREET OR ROAD FRONTING THE PROPERTY.

## **INSPECTIONS:**

THERE ARE A NUMBER OF INSPECTIONS REQUIRED IN EACH OF THE FOUR CODES (BUILDING, ELECTRIC, PLUMBING AND MECHANICAL); THEREFORE YOU MUST CALL WHEN YOU ARE READY FOR EACH TYPE OF INSPECTION. **ALL WORK SHALL BE INSPECTED FOR EACH TRADE AND AN APPROVAL STICKER POSTED, BEFORE WORK CONTINUES. DO NOT REMOVE ANY STICKERS UNTIL ALL FINAL INSPECTIONS ARE COMPLETE AND APPROVED.**

## **THE REQUIRED VISUAL INSPECTIONS ARE AS FOLLOWS:**

### **BUILDING**

**FOUNDATION / FOOTING:** WHEN EXCAVATION IS COMPLETED, FORMS ARE SET, TRENCHES DUG, REQUIRED REINFORCING STEEL IS IN PLACE AND PRIOR TO PLACING ANY CONCRETE. WOOD FOUNDATIONS: STONE AND FOOTING PLATES ARE IN PLACE.

**BACKFILL:** WHEN FOUNDATION WALLS ARE DAMPPROOFED/WATERPROOFED, AN APPROVED DRAINAGE SYSTEM INSTALLED, FOUNDATION ANCHORS INSTALLED PER MANUFACTURERS SPECIFICATIONS AND WALLS BRACED.

**ROUGH MASONRY:** WHEN THE BASE COURSE FLASHINGS AND WEATHER-RESISTANT SHEATHING PAPER HAVE BEEN INSTALLED AND BEFORE THE INSTALLATION OF ANY MASONRY VENEER (BRICK, STONE, ETC.).

**ROUGH FRAME:** (BEFORE INSULATING OR DRYWALL) WHEN THE ROOF, ALL FRAMING, FIRESTOPPING, DRAFTSTOPPING, AND BRACING ARE IN PLACE. EXTERIOR WINDOWS AND DOORS SHALL BE INSTALLED. **THE ELECTRICAL, PLUMBING AND MECHANICAL ROUGH INSPECTIONS HAVE ALL BEEN APPROVED.**

**FIRE RATED ASSEMBLY:** BEFORE WALLS ARE TAPED AND FINISHED (COMMERCIAL ONLY)

**INSULATION INSPECTION:** BEFORE DRYWALL OR OTHER INTERIOR WALL COVERING IS IN PLACE.

**FINAL:** WHEN THE PERMITTED WORK IS COMPLETE AND PRIOR TO OCCUPANCY. THE ELECTRICAL, MECHANICALS & PLUMBING FINAL INSPECTIONS HAVE ALL BEEN APPROVED. **SITE ADDRESS INSTALLED PER THE 911 ORDINANCES.** (4" MINIMUM ON THE STRUCTURE, 3" MINIMUM ON A POST 3½' - 5' TALL, OR ON A MAILBOX "POST" LOCATED ON THE LEFT HAND SIDE OF THE DRIVEWAY AS YOU ENTER THE PROPERTY AND VISIBLE FROM BOTH SIDES.)

### **ELECTRICAL**

**TEMPORARY SERVICE:** WHEN TEMPORARY SERVICE IS COMPLETE AND READY FOR HOOKUP. IT SHALL HAVE ONE (1) GROUND ROD AND A GROUNDFAULT OUTLET. **A REQUEST NUMBER IS REQUIRED.**

**PERMANENT SERVICE:** WHEN PERMANENT SERVICE IS COMPLETE AND READY FOR HOOKUP. IT SHALL HAVE TWO (2) GROUND RODS SPACED A MINIMUM OF 6 FEET APART AND A GROUNDFAULT OUTLET. **A REQUEST NUMBER IS REQUIRED.**

**UNDERGROUND:** WHILE TRENCH IS OPEN.

**ROUGH IN:** WHEN WIRE IS PULLED, BOXES MADE UP (NO FIXTURES INSTALLED) AND SERVICE IS READY TO BE RELEASED. ALL PENETRATIONS THROUGH PLATES, AT 10-FOOT INTERVALS IN WALL CAVITIES, AND INTO RETURN AIR RUNS SHALL BE FIRE STOPPED.

**FINAL:** WHEN ALL FIXTURES ARE SET AND COVERS PLATES ARE ON.

**ELECTRICAL:** JOHN KEETCH, (517) 255 3722

**MECHANICAL:** JOE HARDIN, (248) 866 5765

**PLUMBING:** JOHN POMAVILLE, (517) 749 7707

INSPECTORS MAY MAKE OR REQUIRE **OTHER INSPECTIONS** TO ASCERTAIN COMPLIANCE WITH THE CODES.

PLEASE REMEMBER EACH JOB IS DIFFERENT AND GOES AT DIFFERENT PACES. THEREFORE, WE HAVE NO IDEA WHEN YOU WILL BE READY FOR AN INSPECTION. PLEASE CALL AND LET US KNOW. MAKE SURE YOU ARE READY FOR THE INSPECTION. IF AN INSPECTION IS REQUESTED AND IS NOT READY OR THE BUILDING IS LOCKED, **A RE-INSPECTION IS REQUIRED AND A FEE WILL BE CHARGED.**

**DO NOT TO COVER ANY WORK UNTIL ALL APPROVALS ARE GIVEN.**

TO REQUEST INSPECTIONS, CALL ROB KEHOE (810) 516 1191

WHEN CALLING FOR AN INSPECTION BE SURE TO HAVE THE FOLLOWING INFORMATION READY:

- A. ADDRESS OF PROJECT
- B. CONTACT NAME AND TELEPHONE NUMBER
- C. TYPE OF PROJECT (NEW HOME, ADDITION, COMMERCIAL, ETC...)
- D. TYPE OF INSPECTION REQUESTED (UNDERGROUND, ROUGH, FINAL OR REINSPECTION, ETC.,
- E. IF HOME IS OPEN OR IF THERE IS A KEY OR LOCK BOX CODE FOR THE INSPECTOR

Revised 3/22/2024



## INSPECTION REQUEST INFORMATION

INSPECTION REQUEST LINE: (810) 516-1191

ELECTRICAL INSPECTIONS – John Keetch (517) 256-3722

MECHANICAL INSPECTIONS – Joe Hardin (248) 866-5765

PLUMBING INSPECTIONS – John Pomaville (517) 749-3707

PLEASE HAVE THE FOLLOWING INFORMATION READY:

ADDRESS OF PROJECT

TYPE OF PERMIT

(Building, Electrical)

TYPE OF INSPECTION

(Underground, Rough, Final, etc.)

CONTACT INFORMATION OF THE PERSON REQUESTING THE INSPECTION.

HOW TO GAIN ACCESS TO PROJECT

(Key Location, Lock Box Number, Open, etc.)

**ADDITIONAL INSPECTIONS AND REINSPECTIONS ARE SUBJECT TO ADDITIONAL FEES.**

**TO CONTACT AN INSPECTOR CALL THE MAIN OFFICE (810) 516-1191**

# POLE BUILDING PLAN REVIEW REQUIREMENTS

Depth and diameter of post footing

Size of posts and spacing

Size and spacing of sidewall purlins

Size and number of truss carriers/headers

Type and location of truss ties/blocks

Roof framing materials (pre-engineered trusses or rafters)

Type of roof sheathing

All door and window sizes, including locations

A description of the exterior coverings

Overhead plan view showing post locations

The above items are a general list to start the plan review, if you have any circumstances that may affect the final approval of your project, please address these on your plans.

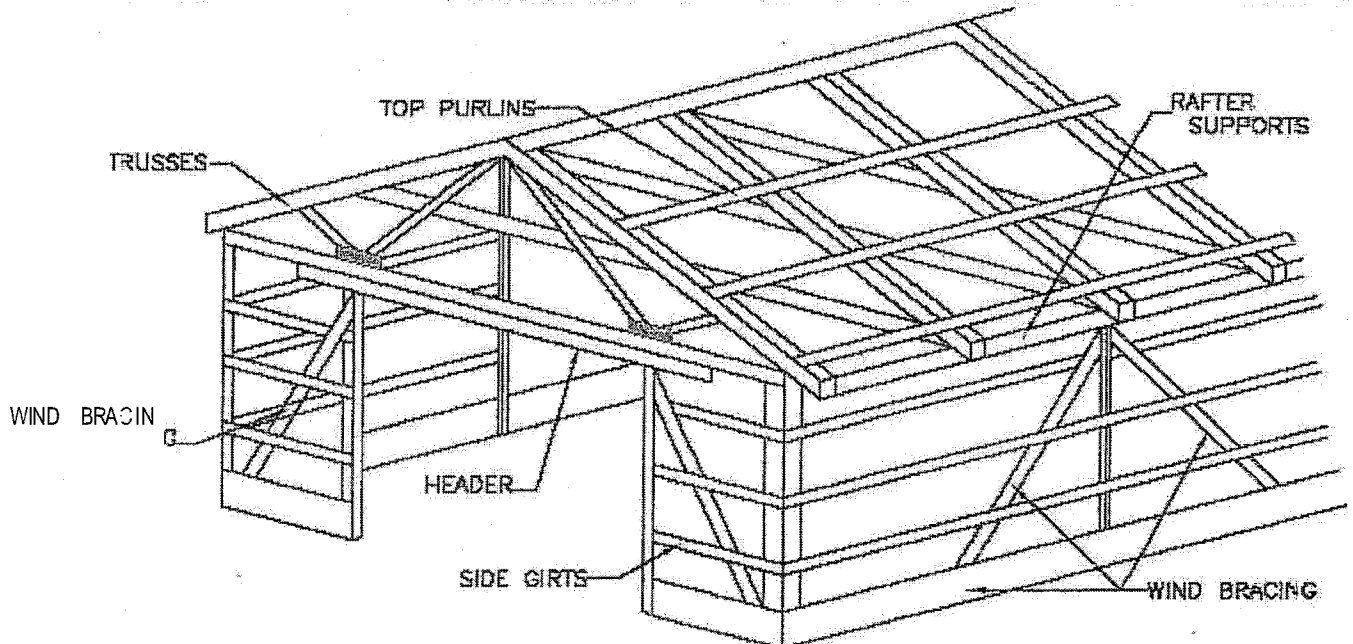

**SPECIFICATIONS:**

1. BUILDING SIZE            x        x  
   L        W        H
2. TRUSSES: YES  NO
3. TRUSS SIZE:        \_\_\_ x<sup>Ⓞ</sup>        \_\_\_ O.C.
4. RAFTERS:            \_\_\_ x \_\_\_        x \_\_\_ O.C.
5. ROOFPITCH:        \_\_\_ / \_\_\_
6. POSTS:              \_\_\_ x \_\_\_        @ \_\_\_ O.C.
7. FOOTINGS:  
(Minimum Depth: 42" or 1/4 of Length of Pole)
8. MAIN DOOR HEADER:        \_\_\_ x \_\_\_ & \_\_\_
9. TOP GIRTS:         \_\_\_ x \_\_\_        @        O.C.
10. SIDE GIRTS:        \_\_\_ x \_\_\_        @ \_\_\_ O.C.
11. CONCRETE FLOOR: YES  NO

Signature \_\_\_\_\_

**POLE SPACING INFORMATION: (Circle One)**

POLE SPACE	BLDG WIDTH	PAD DIAMETER
8'	24'	12"
8'	26'	16"
8'	30'	18"
8'	36'	20"
8'	40'	24"

**TRUSS CARRIERS: (Circle One)**

8'	24'	2 - 2" x 12"
8'	26'	2 - 2" x 12"
8'	36'	2 - 2" x 12"
8'	30'	2 - 2" x 12"
8'	40'	3 - 2" x 12"

**WIND BRACING**

Wind pressure on the walls will cause the pole to bend at the ground line. A WIND BRACE should be provided at the eave line for buildings with a side wall height of over 10', and for buildings 60' long and over. The BRACE should be a 2" x 4" at least 12' long, extending from the pole to the rafter at an angle of 45° to the side wall.

**FASTENERS**

Fasteners for preservative-treated wood shall be of hot-dipped zinc-coated galvanized steel, stainless steel, silicon bronze or copper.

**BRACING IN ROOF**

Lateral support of the trusses - refer to manufactures truss dwg. - Bldg Inspector to be given a copy.

**CONCRETE PAD**

Minimum of 8" inches thick  
2500 PSI concrete.  
**NO DRY MIX FOR PADS**

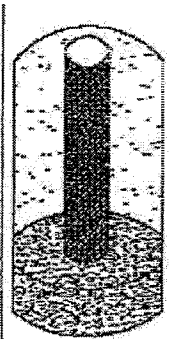

**SUPPORTS FOR 8' POLE SPACING ONLY: (Circle One)**

EAVE HEIGHT:	LENGTH
8' - 4" x 6"	thru 24'
10' - 4" x 6"	thru 40'
10' - 6" x 6"	thru 60'
12' - 6" x 6"	thru 50'

## FOOTING SIZES FOR POLE BUILDINGS

THIS IS FOR 3000# PER SQUARE FOOT SOIL CAPACITY

WIDTH OF BUILDING	POLE SPACING FOR ONE STORY BUILDINGS						
	4 FEET	6 FEET	8 FEET	10 FEET	12 FEET	14 FEET	16 FEET
16 FEET	6"X12"	6"X12"	6"X14"	6"X14"	8"X16"	8"X18"	8"X18"
20 FEET	6"X12"	6"X12"	6"X14"	8"X16"	8"X18"	10"X20"	10"X20"
24 FEET	6"X12"	8"X16"	8"X16"	8"X18"	10"X20"	10"X22"	10"X22"
28 FEET	6"X12"	8"X16"	8"X18"	10"X20"	10"X22"	10"X22"	12"X24"
32 FEET	6"X12"	8"X16"	8"X18"	10"X20"	10"X22"	12"X24"	12"X26"
36 FEET	6"X12"	8"X18"	10"X20"	10"X22"	12"X24"	12"X26"	12"X28"
40 FEET	6"X14"	8"X18"	10"X20"	12"X24"	12"X26"	12"X28"	12"X28"
44 FEET	8"X16"	8"X18"	10"X22"	12"X24"	12"X26"	12"X28"	14"X30"
48 FEET	8"X16"	10"X20"	10"X22"	12"X26"	12"X28"	14"X30"	14"X32"
52 FEET	8"X16"	10"X20"	12"X24"	12"X26"	12"X28"	14"X30"	14"X32"
56 FEET	8"X18"	10"X22"	12"X24"	12"X28"	14"X30"	14"X32"	16"X34"
60 FEET	8"X18"	10"X22"	12"X26"	12"X28"	14"X30"	16"X34"	16"X36"
64 FEET	8"X18"	10"X22"	12"X26"	12"X28"	14"X32"	16"X34"	16"X36"

## FOOTING CONCRETE

FOOTING SIZE	APPROXIMATE NUMBER OF REDI-MIX BAGS OF CONCRETE*		FOOTING SIZE	APPROXIMATE NUMBER OF REDI-MIX BAGS OF CONCRETE*	
	80# BAGS	50# BAGS		80# BAGS	50# BAGS
6"X12"	¾ BAG	1 BAG	12"X26"	5½ BAGS	9 BAGS
6"X14"	1 BAG	1¼ BAGS	12"X28"	6½ BAGS	10½ BAGS
8"X16"	1½ BAGS	2¼ BAGS	14"X30"	6¾ BAGS	14 BAGS
8"X18"	2 BAGS	3 BAGS	14"X32"	7 BAGS	15½ BAGS
10"X20"	2½ BAGS	4½ BAGS	16"X34"	12½ BAGS	20½ BAGS
10"X22"	3½ BAGS	5½ BAGS	16"X36"	14½ BAGS	23 BAGS
12"X24"	4¾ BAGS	7¾ BAGS		NOT USED	

\*Above numbers are rounded to nearest ¼ bag. 1½ - 80 pound bags or 2½ - 50 pound bags equal approximately 1 cubic foot of mixed concrete based on information provided by QUIKRETE® Concrete Supply Company.

## CARRIER SIZES FOR POLE BUILDINGS

THIS IS FOR SPRUCE-PINE-FIR #1 OR BETTER, DRESSED LUMBER

WIDTH OF BUILDING	POLE SPACING FOR ONE STORY BUILDINGS						
	4 FEET	6 FEET	8 FEET	10 FEET	12 FEET	14 FEET	16 FEET
16 FEET	2-2"X4"	2-2"X6"	2-2"X8"	2-2"X10"	A* 2-2"X12"	C* 3-2"X12"	C* 3-2"X12"
20 FEET	2-2"X6"	2-2"X8"	2-2"X8"	2-2"X10"	A* 2-2"X12"	C* 3-2"X12"	4-2"X12"
24 FEET	2-2"X6"	2-2"X8"	2-2"X10"	2-2"X10"	A* 2-2"X12"	C* 3-2"X12"	4-2"X12"
28 FEET	2-2"X8"	2-2"X10"	A* 2-2"X12"	C* 3-2"X12"	4-2"X12"		
32 FEET	2-2"X8"	A* 2-2"X12"	A* 2-2"X12"	C* 3-2"X12"	4-2"X12"		
36 FEET	2-2"X8"	A* 2-2"X12"	C* 3-2"X12"	4-2"X12"	4-2"X12"		
40 FEET	2-2"X10"	B* 3-2"X10"	C* 3-2"X12"	4-2"X12"			
44 FEET	2-2"X10"	B* 3-2"X10"	4-2"X10"	4-2"X12"			
48 FEET	A* 2-2"X12"	C* 3-2"X12"	4-2"X12"				
52 FEET	A* 2-2"X12"	C* 3-2"X12"	4-2"X12"				
56 FEET	A* 2-2"X12"	C* 3-2"X12"	4-2"X12"				
60 FEET	B* 3-2"X10"	4-2"X10"					
64 FEET	B* 3-2"X10"	4-2"X10"					

MUST BE ENGINEERED

		SPECIAL NOTE
A*	3-2"X10" MAY BE USED INSTEAD OF 2-2"X12"	BUILDINGS WITH POSTS SPACED 8ft. ON CENTER AND A WALL HEIGHT BETWEEN 11ft. AND 14ft. MUST USE 6in. x 6in. POSTS.
B*	4-2"X8" MAY BE USED INSTEAD OF 3-2"X10"	
C*	4-2"X10" MAY BE USED INSTEAD OF 3-2"X12"	

EFFECTIVE DATE: 12 DEC 2009