

City of Laingsburg Development Department  
114 N Woodhull P.O. Box 178  
Laingsburg, MI 48848  
Ph: (517) 651-5374 Email: [clerk@laingsburg.us](mailto:clerk@laingsburg.us)  
<https://www.shiawassee.net/Community-Development/>

## POLE BUILDING PERMIT CHECKLIST

### ZONING PERMIT

- \_\_\_\_\_ 1. Completed **Zoning Permit Application\***.
- \_\_\_\_\_ 2. **Proof of Ownership** if purchased within the last year.
- \_\_\_\_\_ 3. **Completed Site Plan Grid**
  - a. Minimum site plan requirements are listed on Page 4 of this packet.
  - b. A sample site plan grid is listed on Page 5 of this packet.
- \_\_\_\_\_ 4. **Soil Erosion and Sedimentation Review:** A soil erosion review is required by the State of Michigan through Shiawassee County Environmental Health. Additional information can be found [here](#).

### BUILDING PERMIT

(Contractors must be registered with the Building Department)

- \_\_\_\_\_ 1. Completed **Building Permit Application** form.
- \_\_\_\_\_ 2. **Blueprints and/or Plans:** A **complete** set of building and foundation plans and specifications, including a cross-section of the proposed project.
- \_\_\_\_\_ 3. Completed **Truss Drawings** submitted with this application packet.

APPLICATIONS WILL NOT BE PROCESSED UNTIL ALL DOCUMENTATION HAS BEEN RECEIVED

\*Commercial and Industrial construction requires Site Plan Review Approval

# APPLICATION for a ZONING PERMIT

City of Laingsburg

114 N Woodhull

P.O. Box 178

Laingsburg, Mi 48848

Phone: (517) 651-5374 • Fax: (517) 651-5512

Email: clerk@laingsburg.us

App. Date: \_\_\_\_\_ Receipt # \_\_\_\_\_ Fee: \$ \_\_\_\_\_ Permit # \_\_\_\_\_

Review Date: \_\_\_\_\_ ☐ Approved ☐ Denied By: \_\_\_\_\_

Property Address/Location		Applicant (if not Owner)		
Address/Street: _____		Name: _____		
Nearest Cross Rd.: _____		Address: _____		
Township: _____		City/State/Zip: _____		
Parcel Number: _____		Phone: _____		
Zoning District: _____		Fax/Email: _____		
Owner Information		If New Construction or Addition		
Name: _____		<b>Please Attach All That Apply:</b> <input type="checkbox"/> Land Division Certificate <input type="checkbox"/> Survey <input type="checkbox"/> Proof of Ownership <input type="checkbox"/> Septic Permit # _____ Well Permit # _____ <input type="checkbox"/> Driveway Permit <input type="checkbox"/> Soil Erosion Permit <input type="checkbox"/> New Address <input type="checkbox"/> New Sewer Connection		
Address: _____				
City/State/Zip: _____				
Phone: _____				
Fax/Email: _____				
Type of Request		Yes	No	For All Applications
<input type="checkbox"/> Principal Structure				Did you attach a "Site Plan Drawing"?
<input type="checkbox"/> Accessory Structure				Are you making grade (earth) changes?
<input type="checkbox"/> Agricultural Structure				Is your project within 500 ft. of surface water?
<input type="checkbox"/> Temporary Structure/Use				Is this site currently violating the Ordinance?
<input type="checkbox"/> Demolition Permit				
<input type="checkbox"/> Sign				
<input type="checkbox"/> Home Occupation				
<input type="checkbox"/> Fence				<b>For Sign Permits Only</b>
<input type="checkbox"/> Deck or Porch				Type of Business: _____
<input type="checkbox"/> Pool				Total display area in square feet: _____
<input type="checkbox"/> Solar				Proposed setback from Right-of-Way: _____
<input type="checkbox"/> Outdoor Solid Fuel Furnace				Sign height: _____ Sign purpose: _____
<input type="checkbox"/> Shared Driveway				Type: <input type="checkbox"/> Pole <input type="checkbox"/> Ground <input type="checkbox"/> Wall <input type="checkbox"/> Other
<input type="checkbox"/> Buildable Lot Study				Height and width of wall: _____
<input type="checkbox"/> Hazardous Material Storage				Attach Sign drawing showing copy <input type="checkbox"/>
<input type="checkbox"/> Other: _____				
<b>Describe Proposed Building or Land Use:</b> _____ _____ _____				

## AFFIDAVIT OF COMPLIANCE

I am the owner of, or the authorized agent of the owner, of the lot (parcel of land) described and shown on the attached site plan. I am familiar with the Shiawassee County Zoning Ordinance, including the related laws listed in Section 16.5.3. I hereby attest based upon my knowledge and belief that this request is complete, in compliance with, and warrants approval under the Shiawassee County Zoning Ordinance of 1999, as amended.

Signature of Applicant \_\_\_\_\_

Date \_\_\_\_\_

# CITY OF LAINGSBURG ZONING SITE PLAN GRID

NAME: \_\_\_\_\_ PROJECT ADDRESS: \_\_\_\_\_

LOT SIZE: \_\_\_\_\_ or NUMBER OF ACRES \_\_\_\_\_.

(SEE REVERSE SIDE FOR INSTRUCTIONS)

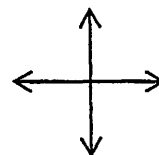

(E, N, S, W,)

CENTER LINE OF ROAD

## **SITE PLAN REQUIREMENTS**

1. List Setbacks from all lot lines accurately.
2. Indicate all buildings on site and the distance between them.
3. Show location of all utility lines and distance from current building site.
4. Show location of the Well, Septic Tank and Drain Field.
5. Show location of the Reserve Drain Field.
6. Accurately locate Driveway and give distance from closest lot line.
7. Indicate any unique features of the property, such as drain, ditches or streams, etc. and the distance for the building site.

# SAMPLE

## SHIAWASSEE COUNTY ZONING SITE PLAN GRID

NAME John Doe PROJECT ADDRESS 1000 E. COPPER RD.

LOT SIZE 200 X 320 or NUMBER OF ACRES \_\_\_\_\_

(SEE REVERSE SIDE FOR INSTRUCTOINS)

200'

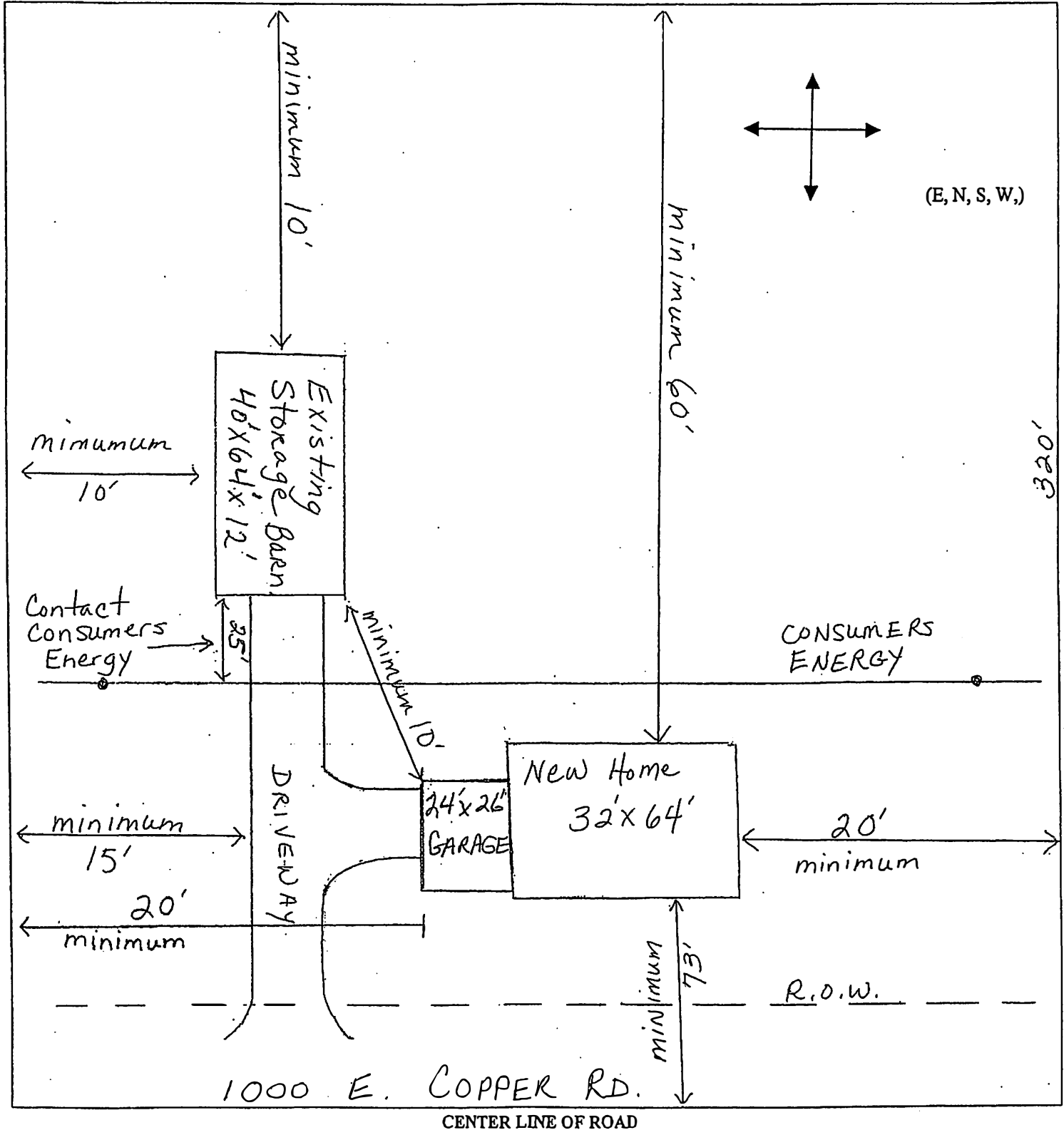

This application shall become incorporated as a part of the permit and only authorizes the items of work as herein applied for, as described on the issued permit.

# BUILDING PERMIT APPLICATION

City of Laingsburg  
114 Woodhull  
Laingsburg, MI 48848  
(517) 651-5374  
Email: [Clerk@laingsburg.us](mailto:Clerk@laingsburg.us)

\*OFFICE USE ONLY\*

PERMIT # \_\_\_\_\_

DATE \_\_\_\_\_

RECEIPT # \_\_\_\_\_

Job Site Address: _____		Township: _____	Property Tax ID #: _____
Property Owner: _____		Email: _____	Phone: _____
Owners Mailing Address, City, State, Zip: _____			
Contractor: _____		Email: _____	Phone: _____
Contractor Address, City, State, Zip: _____			
Alternate Phone/ Contact Information: _____		License #: _____	Expiration Date: _____
Use of Building: _____		Foundation Type: Poured Wall <input type="checkbox"/> Post <input type="checkbox"/> Block <input type="checkbox"/> Wood <input type="checkbox"/> Other <input type="checkbox"/>	
Class of Work: New Home <input type="checkbox"/> Addition <input type="checkbox"/> Alteration <input type="checkbox"/> Accessory Structure <input type="checkbox"/> Basement <input type="checkbox"/> Conventional Frame <input type="checkbox"/> Post Frame <input type="checkbox"/> Modular <input type="checkbox"/>			
HUD Double Wide/ Single Wide <input type="checkbox"/> Structured Steel <input type="checkbox"/>			
Describe Work: _____			
Special Conditions: _____			

NOTICE: SEPARATE PERMITS ARE REQUIRED FOR ELECTRICAL, PLUMBING, HEATING, VENTILATING OR AIR CONDITIONING. THIS PERMIT BECOMES NULL AND VOID IF WORK OR CONSTRUCTION AUTHORIZED IS NOT COMMENCED WITHIN 180 DAYS, OR IF CONSTRUCTION OR WORK IS SUSPENDED OR ABANDONED FOR A PERIOD OF 180 DAYS AT ANY TIME AFTER WORK IS COMMENCED. I HEREBY CERTIFY THAT I HAVE READ AND EXAMINED THIS APPLICATION AND KNOW THE SAME TO BE TRUE AND CORRECT. ALL PROVISIONS OF LAWS AND ORDINANCES GOVERNING THIS TYPE OF WORK WILL BE COMPLIED WITH WHETHER SPECIFIED HEREIN OR NOT. THE GRANTING OF A PERMIT DOES NOT PRESUME TO GIVE AUTHORITY TO VIOLATE OR CANCEL THE PROVISIONS OF ANY OTHER STATE OR LOCAL LAW REGULATING CONSTRUCTION OR THE PERFORMANCE OF CONSTRUCTION.

\*Section 23A of the State Construction Code Act of 1972, 1972 PA 230, MCL 125.1523A, prohibits a person from conspiring to circumvent the licensing requirements of this state relating to persons who are to perform work on a residential building or a residential structure. Violators of Section 23A are subjected to civil fines.

Signature of Contractor or Authorized Agent*	(Date)
Signature of Owner (if owner is doing building)	(Date)

**\*I HEREBY CERTIFY THAT THE PROPOSED WORK IS AUTHORIZED BY THE OWNER OF RECORD AND THAT I HAVE BEEN AUTHORIZED BY THE OWNER TO MAKE THIS APPLICATION AS HIS/HER AUTHORIZED AGENT, AND WE AGREE TO CONFORM TO ALL APPLICABLE LAWS OF THE STATE OF MICHIGAN. ALL INFORMATION SUBMITTED ON THIS APPLICATION IS ACCURATE TO THE BEST OF MY KNOWLEDGE.**

FOR OFFICE USE ONLY			
Administration Fee: \$40.00			
Total Valuation		Permit Fee	
Requirements	Required	Received	Not Required
Contractor Registration			
Zoning			
Plans			
Truss Drawings			
Energy Comp/Blower Door			
Comm. Plan Review Fee			
REQUIRED INSPECTIONS			
<input type="checkbox"/> FOOTING	<input type="checkbox"/> BACKFILL	<input type="checkbox"/> ROUGH	
<input type="checkbox"/> INSULATION	<input type="checkbox"/> FINAL	<input type="checkbox"/> OTHER	

Application Received by:	Plan Reviewed by:	Approved for Issuance by:
--------------------------	-------------------	---------------------------

Date Received

# **SHIAWASSEE COUNTY INSPECTION INFORMATION**

PART OF THE BUILDING PROCESS IS TO IDENTIFY THE JOB LOCATION AND HAVE INSPECTIONS DONE AT SPECIFIC STAGES DURING CONSTRUCTION. BEFORE AN INSPECTOR CAN PERFORM THEIR JOB THE PERMIT HOLDER SHALL OBSERVE THE FOLLOWING RULES.

1: THE BUILDING PERMIT OR COPY SHALL BE KEPT ON SITE UNTIL THE COMPLETION OF THE PROJECT.

2: THE SITE ADDRESS SHALL BE PROVIDED IN SUCH A POSITION TO BE PLAINLY VISABLE AND LEGIBLE FROM THE STREET OR ROAD FRONTING THE PROPERTY.

## **INSPECTIONS:**

THERE ARE A NUMBER OF INSPECTIONS REQUIRED IN EACH OF THE FOUR CODES (BUILDING, ELECTRIC, PLUMBING AND MECHANICAL); THEREFORE YOU MUST CALL WHEN YOU ARE READY FOR EACH TYPE OF INSPECTION. **ALL WORK SHALL BE INSPECTED FOR EACH TRADE AND AN APPROVAL STICKER POSTED, BEFORE WORK CONTINUES. DO NOT REMOVE ANY STICKERS UNTIL ALL FINAL INSPECTIONS ARE COMPLETE AND APPROVED.**

## **THE REQUIRED VISUAL INSPECTIONS ARE AS FOLLOWS:**

### **BUILDING**

**FOUNDATION / FOOTING:** WHEN EXCAVATION IS COMPLETED, FORMS ARE SET, TRENCHES DUG, REQUIRED REINFORCING STEEL IS IN PLACE AND PRIOR TO PLACING ANY CONCRETE. WOOD FOUNDATIONS: STONE AND FOOTING PLATES ARE IN PLACE.

**BACKFILL:** WHEN FOUNDATION WALLS ARE DAMPPROOFED/ WATERPROOFED, AN APPROVED DRAINAGE SYSTEM INSTALLED, FOUNDATION ANCHORS INSTALLED PER MANUFACTURERS SPECIFICATIONS AND WALLS BRACED.

**ROUGH MASONRY:** WHEN THE BASE COURSE FLASHINGS AND WEATHER-RESISTANT SHEATHING PAPER HAVE BEEN INSTALLED AND BEFORE THE INSTALLATION OF ANY MASONRY VENEER (BRICK, STONE, ETC.).

**ROUGH FRAME:** (BEFORE INSULATING OR DRYWALL) WHEN THE ROOF, ALL FRAMING, FIRESTOPPING, DRAFTSTOPPING, AND BRACING ARE IN PLACE. EXTERIOR WINDOWS AND DOORS SHALL BE INSTALLED. **THE ELECTRICAL, PLUMBING AND MECHANICAL ROUGH INSPECTIONS HAVE ALL BEEN APPROVED.**

**FIRE RATED ASSEMBLY:** BEFORE WALLS ARE TAPED AND FINISHED (COMMERCIAL ONLY)

**INSULATION INSPECTION:** BEFORE DRYWALL OR OTHER INTERIOR WALL COVERING IS IN PLACE.

**FINAL:** WHEN THE PERMITTED WORK IS COMPLETE AND PRIOR TO OCCUPANCY. THE ELECTRICAL, MECHANICALS & PLUMBING FINAL INSPECTIONS HAVE ALL BEEN APPROVED. **SITE ADDRESS INSTALLED PER THE 911 ORDINANCES.** (4" MINIMUM ON THE STRUCTURE, 3" MINIMUM ON A POST 3½' - 5' TALL, OR ON A MAILBOX "POST" LOCATED ON THE LEFT HAND SIDE OF THE DRIVEWAY AS YOU ENTER THE PROPERTY AND VISIBLE FROM BOTH SIDES.)

### **ELECTRICAL**

**TEMPORARY SERVICE:** WHEN TEMPORARY SERVICE IS COMPLETE AND READY FOR HOOKUP. IT SHALL HAVE ONE (1) GROUND ROD AND A GROUNDFAULT OUTLET. **A REQUEST NUMBER IS REQUIRED.**

**PERMANENT SERVICE:** WHEN PERMANENT SERVICE IS COMPLETE AND READY FOR HOOKUP. IT SHALL HAVE TWO (2) GROUND RODS SPACED A MINIMUM OF 6 FEET APART AND A GROUNDFAULT OUTLET. **A REQUEST NUMBER IS REQUIRED.**

**UNDERGROUND:** WHILE TRENCH IS OPEN.

**ROUGH IN:** WHEN WIRE IS PULLED, BOXES MADE UP (NO FIXTURES INSTALLED) AND SERVICE IS READY TO BE RELEASED. ALL PENETRATIONS THROUGH PLATES, AT 10-FOOT INTERVALS IN WALL CAVITIES, AND INTO RETURN AIR RUNS SHALL BE FIRE STOPPED.

**FINAL:** WHEN ALL FIXTURES ARE SET AND COVERS PLATES ARE ON.

**MECHANICAL:** \*ADMINISTERED THROUGH THE STATE OF MICHIGAN.\* [www.michigan.gov/bcc](http://www.michigan.gov/bcc)

**PLUMBING:** \*ADMINISTERED THROUGH THE STATE OF MICHIGAN.\* [www.michigan.gov/bcc](http://www.michigan.gov/bcc)

INSPECTORS MAY MAKE OR REQUIRE **OTHER INSPECTIONS** TO ASCERTAIN COMPLIANCE WITH THE CODES.

PLEASE REMEMBER EACH JOB IS DIFFERENT AND GOES AT DIFFERENT PACES. THEREFORE, WE HAVE NO IDEA WHEN YOU WILL BE READY FOR AN INSPECTION. PLEASE CALL AND LET US KNOW. MAKE SURE YOU ARE READY FOR THE INSPECTION. IF AN INSPECTION IS REQUESTED AND IS NOT READY OR THE BUILDING IS LOCKED, **A RE-INSPECTION IS REQUIRED AND A FEE WILL BE CHARGED.**

## **DO NOT TO COVER ANY WORK UNTIL ALL APPROVALS ARE GIVEN.**

TO REQUEST INSPECTIONS, CALL OUR REQUEST LINE AT 989-743-2280 OR EMAIL  
[COMDEV@SHIAWASSEE.NET](mailto:COMDEV@SHIAWASSEE.NET).

WHEN CALLING FOR AN INSPECTION BE SURE TO HAVE THE FOLLOWING INFORMATION READY:

- A. ADDRESS OF PROJECT
- B. CONTACT NAME AND TELEPHONE NUMBER
- C. TYPE OF PROJECT (NEW HOME, ADDITION, COMMERCIAL, ETC...)
- D. TYPE OF INSPECTION REQUESTED (UNDERGROUND, ROUGH, FINAL OR REINSPECTION, ETC.,
- E. IF HOME IS OPEN OR IF THERE IS A KEY OR LOCK BOX CODE FOR THE INSPECTOR

THANK YOU FOR YOUR COOPERATION AND "GOOD LUCK" WITH YOUR PROJECT

SHIAWASSEE COUNTY COMMUNITY DEVELOPMENT - BUILDING DIVISION  
201 NORTH SHIAWASSEE ST, THIRD FLOOR, SURBECK BUILDING  
CORUNNA, MICHIGAN 48817

FOR ANY **QUESTIONS** PLEASE CONTACT THE MAIN OFFICE AT:  
(989) 743-2396

Revised: June 15, 2021



## **INSPECTION REQUEST INFORMATION**

INSPECTION REQUEST LINE: 989-743-2280

**ELECTRICAL INSPECTIONS** – PERFORMED MONDAY AND THURSDAY.  
**BUILDING INSPECTIONS** - PERFORMED MONDAY THROUGH THURSDAY.  
**MECHANICAL & PLUMBING INSPECTIONS** - ARE ADMINISTERED  
THROUGH THE STATE OF MICHIGAN. GO TO [michigan.gov/bcc](http://michigan.gov/bcc) FOR  
ADDITIONAL INSPECTION INFORMATION.

FOR THE CONVENIENCE OF OUR CUSTOMERS, SHIAWASSEE COUNTY  
INSPECTION REQUESTS CAN BE EMAILED TO [comdev@shiawassee.net](mailto:comdev@shiawassee.net).

PLEASE HAVE THE FOLLOWING INFORMATION READY:

ADDRESS OF PROJECT

TYPE OF PERMIT  
(Building, Electrical)

TYPE OF INSPECTION  
(Underground, Rough, Final, etc.)

CONTACT INFORMATION OF THE PERSON REQUESTING THE  
INSPECTION.

HOW TO GAIN ACCESS TO PROJECT  
(Key Location, Lock Box Number, Open, etc.)

**ADDITIONAL INSPECTIONS AND REINSPECTIONS ARE  
SUBJECT TO ADDITIONAL FEES.**

**TO CONTACT AN INSPECTOR CALL THE MAIN OFFICE  
(989) 743-2396**

# POLE BUILDING PLAN REVIEW REQUIREMENTS

Depth and diameter of post footing

Size of posts and spacing

Size and spacing of sidewall purlins  
Size and number of truss carriers/headers

Type and location of truss ties/blocks

Roof framing materials (pre-engineered trusses or rafters)

Type of roof sheathing

All door and window sizes, including locations

A description of the exterior coverings

Overhead plan view showing post locations

The above items are a general list to start the plan review, if you have any circumstances that may affect the final approval of your project, please address these on your plans.



## FOOTING SIZES FOR POLE BUILDINGS

THIS IS FOR 3000# PER SQUARE FOOT SOIL CAPACITY

WIDTH OF BUILDING	POLE SPACING FOR ONE STORY BUILDINGS						
	4 FEET	6 FEET	8 FEET	10 FEET	12 FEET	14 FEET	16 FEET
16 FEET	6"X12"	6"X12"	6"X14"	6"X14"	8"X16"	8"X18"	8"X18"
20 FEET	6"X12"	6"X12"	6"X14"	8"X16"	8"X18"	10"X20"	10"X20"
24 FEET	6"X12"	8"X16"	8"X16"	8"X18"	10"X20"	10"X22"	10"X22"
28 FEET	6"X12"	8"X16"	8"X18"	10"X20"	10"X22"	10"X22"	12"X24"
32 FEET	6"X12"	8"X16"	8"X18"	10"X20"	10"X22"	12"X24"	12"X26"
36 FEET	6"X12"	8"X18"	10"X20"	10"X22"	12"X24"	12"X26"	12"X28"
40 FEET	6"X14"	8"X18"	10"X20"	12"X24"	12"X26"	12"X28"	12"X28"
44 FEET	8"X16"	8"X18"	10"X22"	12"X24"	12"X26"	12"X28"	14"X30"
48 FEET	8"X16"	10"X20"	10"X22"	12"X26"	12"X28"	14"X30"	14"X32"
52 FEET	8"X16"	10"X20"	12"X24"	12"X26"	12"X28"	14"X30"	14"X32"
56 FEET	8"X18"	10"X22"	12"X24"	12"X28"	14"X30"	14"X32"	16"X34"
60 FEET	8"X18"	10"X22"	12"X26"	12"X28"	14"X30"	16"X34"	16"X36"
64 FEET	8"X18"	10"X22"	12"X26"	12"X28"	14"X32"	16"X34"	16"X36"

## FOOTING CONCRETE

FOOTING SIZE	APPROXIMATE NUMBER OF REDI-MIX BAGS OF CONCRETE*		FOOTING SIZE	APPROXIMATE NUMBER OF REDI-MIX BAGS OF CONCRETE*	
	80# BAGS	50# BAGS		80# BAGS	50# BAGS
6"X12"	¾ BAG	1 BAG	12"X26"	5½ BAGS	9 BAGS
6"X14"	1 BAG	1¼ BAGS	12"X28"	5½ BAGS	10½ BAGS
8"X16"	1½ BAGS	2¼ BAGS	14"X30"	6½ BAGS	14 BAGS
8"X18"	2 BAGS	3 BAGS	14"X32"	10 BAGS	15½ BAGS
10"X20"	2½ BAGS	4½ BAGS	16"X34"	12½ BAGS	20½ BAGS
10"X22"	3½ BAGS	5½ BAGS	16"X36"	14½ BAGS	23 BAGS
12"X24"	4½ BAGS	7¾ BAGS	NOT USED		
*Above numbers are rounded to nearest ¼ bag. 1½ - 80 pound bags or 2½ - 50 pound bags equal approximately 1 cubic foot of mixed concrete based on information provided by QUIKRETE® Concrete Supply Company.					

## CARRIER SIZES FOR POLE BUILDINGS

THIS IS FOR SPRUCE-PINE-FIR #1 OR BETTER, DRESSED LUMBER

WIDTH OF BUILDING	POLE SPACING FOR ONE STORY BUILDINGS														
	4 FEET	6 FEET	8 FEET	10 FEET	12 FEET	14 FEET	16 FEET								
16 FEET	2-2"X4"	2-2"X6"	2-2"X8"	2-2"X10"	A* 2-2"X12"	C* 3-2"X12"	C* 3-2"X12"								
20 FEET	2-2"X6"	2-2"X8"	2-2"X8"	2-2"X10"	A* 2-2"X12"	C* 3-2"X12"	4-2"X12"								
24 FEET	2-2"X6"	2-2"X8"	2-2"X10"	2-2"X10"	A* 2-2"X12"	C* 3-2"X12"	4-2"X12"								
28 FEET	2-2"X8"	2-2"X10"	A* 2-2"X12"	C* 3-2"X12"	4-2"X12"	MUST BE ENGINEERED									
32 FEET	2-2"X8"	A* 2-2"X12"	A* 2-2"X12"	C* 3-2"X12"	4-2"X12"										
36 FEET	2-2"X8"	A* 2-2"X12"	C* 3-2"X12"	4-2"X12"	4-2"X12"										
40 FEET	2-2"X10"	B* 3-2"X10"	C* 3-2"X12"	4-2"X12"											
44 FEET	2-2"X10"	B* 3-2"X10"	4-2"X10"	4-2"X12"											
48 FEET	A* 2-2"X12"	C* 3-2"X12"	4-2"X12"												
52 FEET	A* 2-2"X12"	C* 3-2"X12"	4-2"X12"												
56 FEET	A* 2-2"X12"	C* 3-2"X12"	4-2"X12"												
60 FEET	B* 3-2"X10"	4-2"X10"													
64 FEET	B* 3-2"X10"	4-2"X10"													

A*	3-2"X10" MAY BE USED INSTEAD OF 2-2"X12"	SPECIAL NOTE BUILDINGS WITH POSTS SPACED 8ft. ON CENTER AND A WALL HEIGHT BETWEEN 11ft. AND 14ft. MUST USE 6in. x 6in. POSTS.
B*	4-2"X8" MAY BE USED INSTEAD OF 3-2"X10"	
C*	4-2"X10" MAY BE USED INSTEAD OF 3-2"X12"	

EFFECTIVE DATE: 12 DEC 2009